



## Transportable House

12m x 5m / 60m<sup>2</sup>  
3 bedroom option



Our 3 brm 60m<sup>2</sup> Transportable Home includes a double bedroom, 2 single bedrooms, separate living and full sized kitchen. It can also be configured with only 2 bedrooms to allow more space.

Cash price  
**\$146,000**

Finance for 10 years  
**\$531 p/w\***

Finance for 8 years  
**\$587 p/w\***

\*See details below



### Council Code of Compliance

All units are built by a Licensed Building Practitioner and come with a CCC (ex factory).



### 10 Year Warranty

As the law requires, all our units come with a minimum 10 year watertightness and structural warranty.



### Vented Cavity

All units come with a vented cavity for improved water-tightness and durability



### Fully Insured

All our units are fully insured during build, during delivery and with their CCC can be insured ongoing by you the buyer.

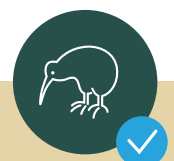

### Kiwi Made

All units have traditional NZ timber framing, Kiwi joinery, roofing, cladding and lining as you would expect in any good quality home.

# Transportable House

12m x 5m / 60m<sup>2</sup>  
3 bedroom option

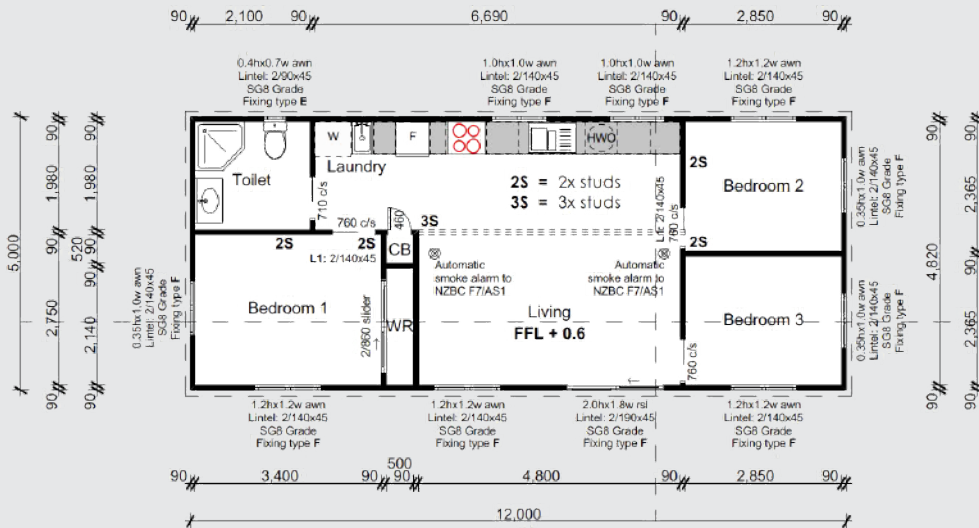

Standard kitchen

Upgraded kitchen

Standard colours

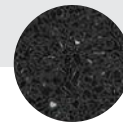
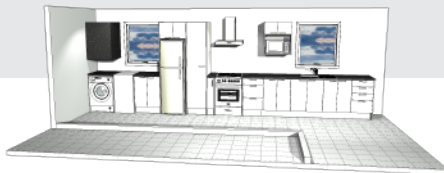

**Benchtop**  
Sonora Black



**Carpet**  
Fairview



**Vinyl flooring**  
533

## What's included

- Transportable Cabin
- Double glazing RO .37
- One master bedroom plus two extra bedrooms
- Separate living
- Full-sized kitchen
- Ensuite bathroom
- Toilet, shower, vanity
- Electric HWC included/Gas optional extra
- Front ranch slider door
- A small rear window in the bathroom
- 4x windows in the living area
- 2x window in the master bedroom
- 1x window in the single bedrooms
- Double power points
- 1.2 x 1.2 deck module (larger decks can be purchased)
- Carpet/Vinyl
- Led lights (interior and exterior)
- Smoke detection

## Optional extras

Extra TV or power points, French Doors / Stacker Sliders, Saniflo Wastewater System, Gas Califont (HW), Electric / Gas Oven, Splash back, Rangehood, Upright pantry, Extra decking / steps, Heat pump, Breakfast bar, Dishwasher, Washing machine

## Pricing and Finance details

Cash price	Weekly payment	Loan term & interest rate	Total interest charges	Total loan repayment	Minimum deposit
<b>\$146,000</b>	<b>\$531</b>	10 years at 15.90%	\$137,533.84	\$276,533.84	\$7,500
	<b>\$587</b>	8 years at 15.90%	\$105,946.30	\$244,928.30	\$7,500

## Important Information

- Cash Price includes GST.
- All units come with kitchen and bathroom, except Sleep Out 4.1 x 2.4m. For specifications of each unit, visit [unit2go.co.nz](http://unit2go.co.nz).
- Cash Prices are ex-factory meaning delivery costs of the unit are not included. Delivery starts at \$1,150 and increases depending on the size of the unit and distance from Auckland. Contact Unit2Go for an estimate of the likely cost. Delivery costs and the minimum deposit must be paid up front.
- The Loan Establishment Fee is \$480. The weekly payments shown above have been worked out on the basis that this fee is financed. This fee can be paid separately by you.
- Interest rate quoted is fixed annual rate for the term of the loan.
- The finance is offered by UFinance Limited. If you wish to finance the unit you will need to complete UFinance's application and are subject to UFinance credit and lending criteria. See [ufinance.co.nz](http://ufinance.co.nz) for full terms and conditions.



New Zealand Made  
license nr: 803176



Licensed Building  
Practitioner

**unit2go**  
— a home to own.

Call: 0800 unit2go (0800 864 824)  
Mon – Thurs 8:30am – 4pm, Fri 8:30am – 1pm  
Outside these hours by appointment only.

[sales@unit2go.co.nz](mailto:sales@unit2go.co.nz)  
141 Boundary Road,  
Papakura 2110, Auckland